

YZF Shaded Pole Motors

YZF 系列产品概述 Summary of YZF Series Shaded Pole Motors

- YZF系列电机为单相、4极的罩极式电动机，额定电压为220~240V，50/60Hz或110~120V，60Hz。可以特殊订制110V/220V双压电机。广泛应用在散热器、蒸发器制冷设备和小型通风设备。
- 电机使用的所有原材料均通过RoHS认证。
- 电机的输出功率范围从2W到34W，通过改变铁芯厚度和绕线参数来调整电机的输出功率。
- 电机的绝缘等级为B级，防护等级为IP42。可根据客户要求生产绝缘等级为F、H级电机，防护等级为IP44的电机。
- 输出功率在10W以下的电机采用阻抗保护，输出功率大于10W采用热保护器，热保护器的断开温度为125℃±5℃、135℃±5℃或150℃±5℃。
- 一般电机适用环境温度为-30℃~50℃。
- 由于我厂生产的标准电机是采用含油轴承，所以工厂建议采用水平方式安装电机，同时我们也可根据客户要求生产滚动轴承电机。
- 电机平均使用寿命为20000小时以上。
- 大部分的电机通过CCC、CE、VDE、UL认证。
- 电机使用前，必须将电机接地线与外部接地装置有效连接。
- YZF series motors are shaded pole motors with single phase, 4 shaded poles and running at rated voltage of 220~240V, 50/60Hz or 110~120V, 60Hz. They are widely used in the radiator, evaporator and other refrigeration equipment.
- All material conform to RoHS.
- The output power is from 2W to 34W, Which is relative to the stack length and coil parameters.
- The insulation class of motors is B, and the protection class of that is IP42. On request IP44 is available.
- The motor, which output power less than 10W are impedance protection and the motors, which output is bigger than 10W, are thermal protected. The thermal protector's is 125℃±5℃, 135℃±5℃ or 150℃±5℃.
- The applicable ambient temperature is from -30℃~50℃.
- Because our standard motors adopt sleeve bearing, we suggest installing these motors horizontally. On request motors can be furnished with ball bearings.
- The average service life of motors is over 20000 hours.
- Most of shaded pole motors passed CE VDE UL and CCC approval.
- Before operating the motor, make sure the earth wire of the motor connected with the external grounding device.

型号说明 Illustration of model

YZF 5 - 13 - 18

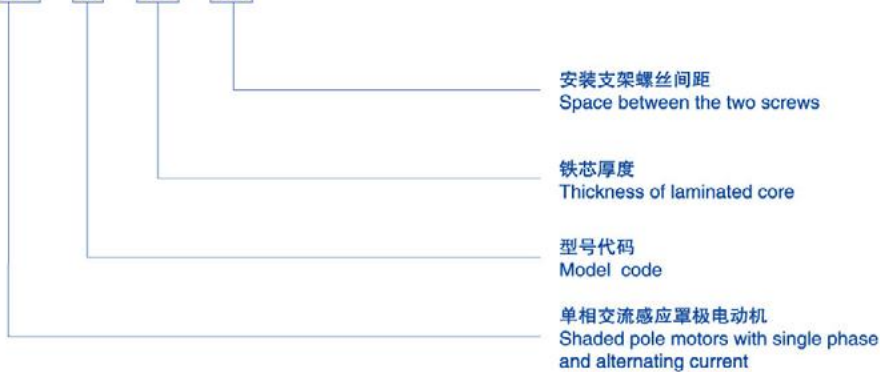

YZF26 罩极电机 Shaded Pole Motors

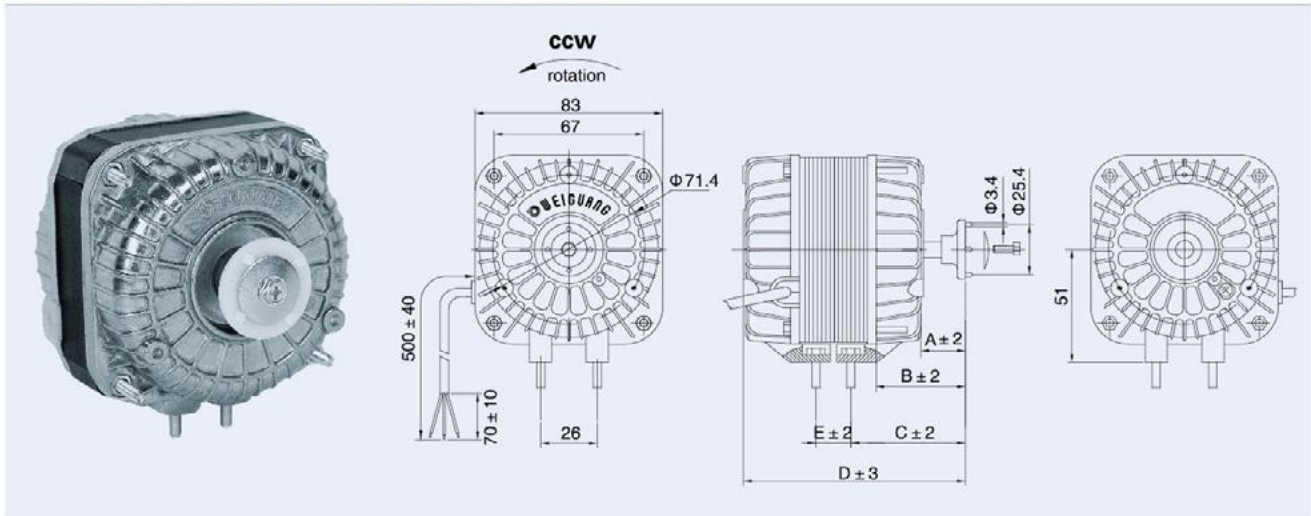

YZF18 罩极电机 Shaded Pole Motors

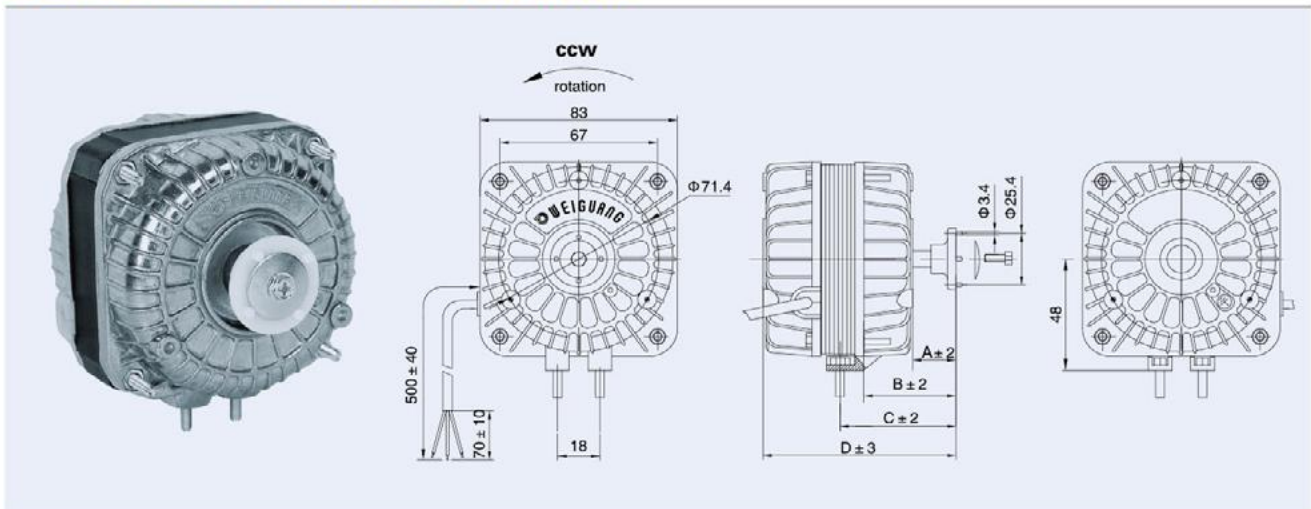

YZF18/26 罩极电机 Shaded Pole Motors

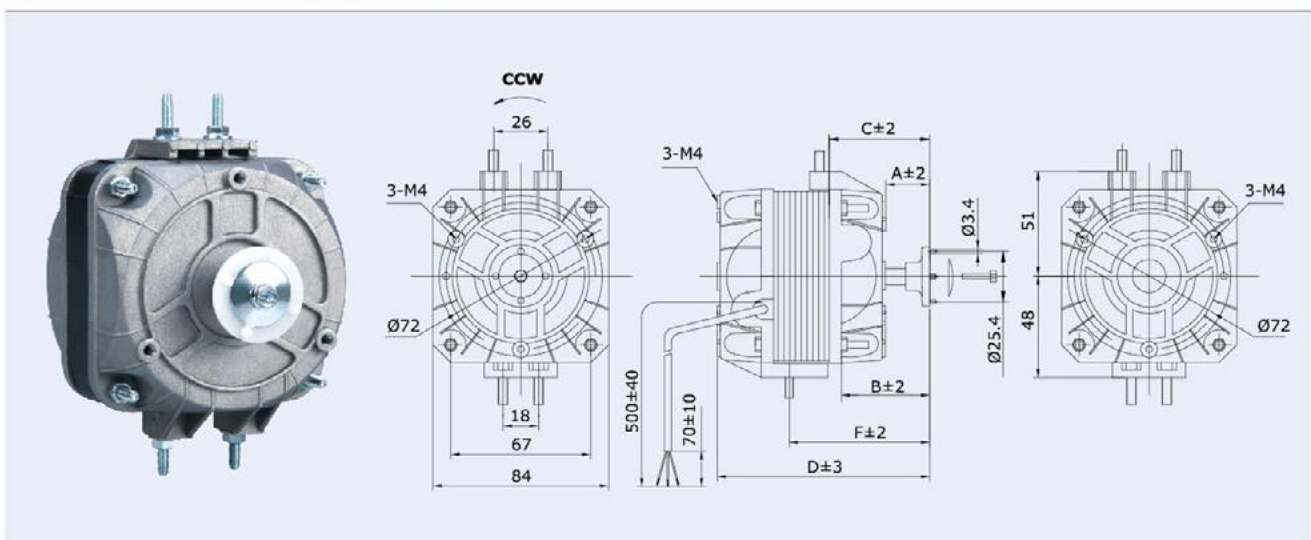

YZFOO 罩极电机 Shaded Pole Motors

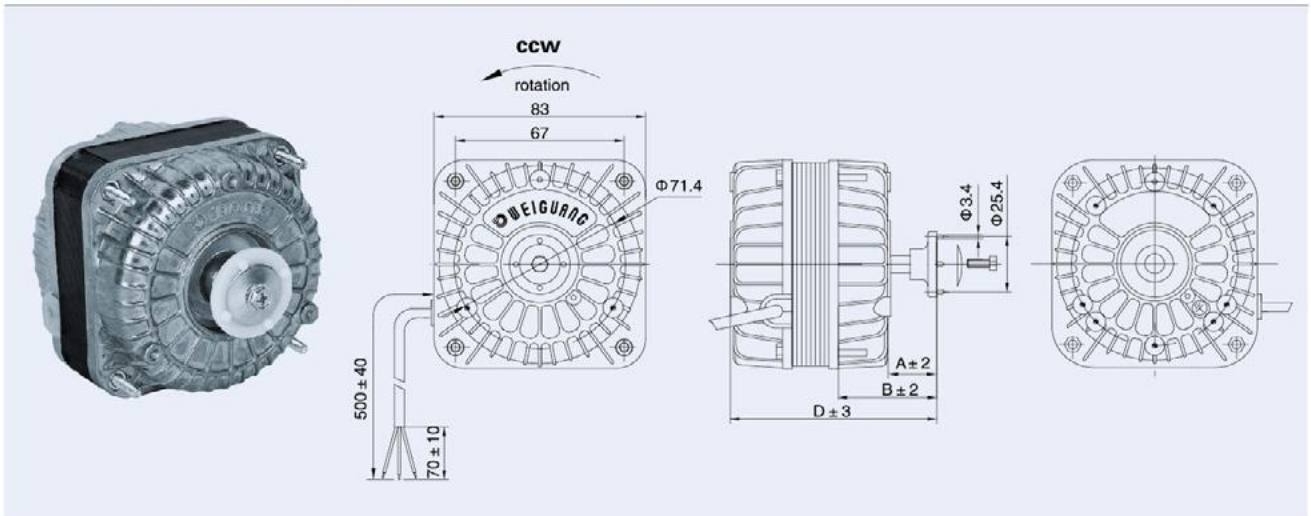

YZF-P 带端子电机 With Pin Terminal Motors

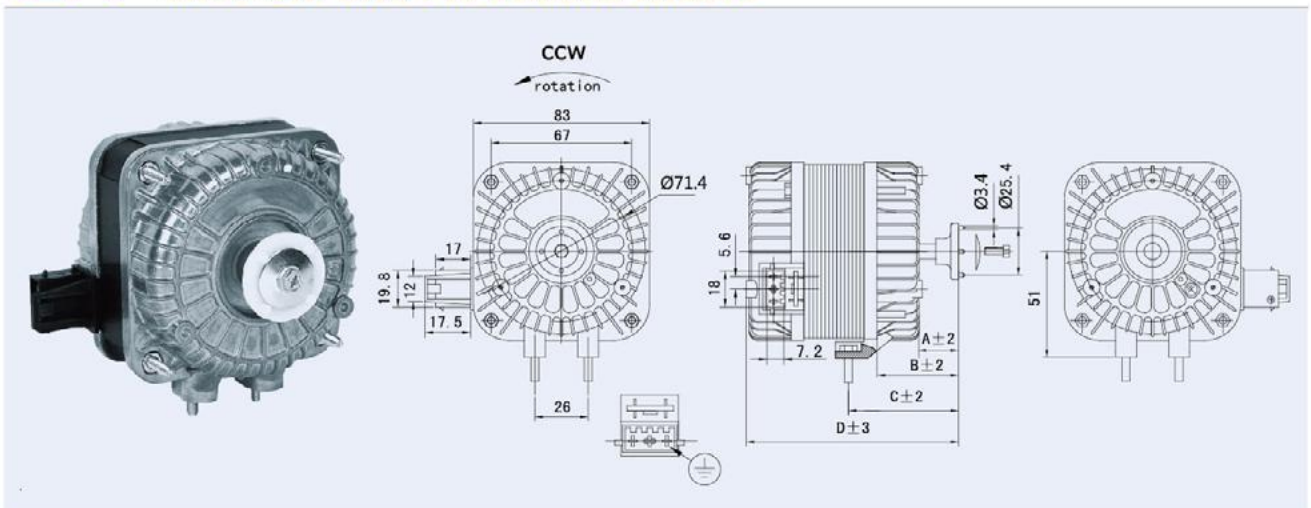

YZF 带插头电机 Motors with plug

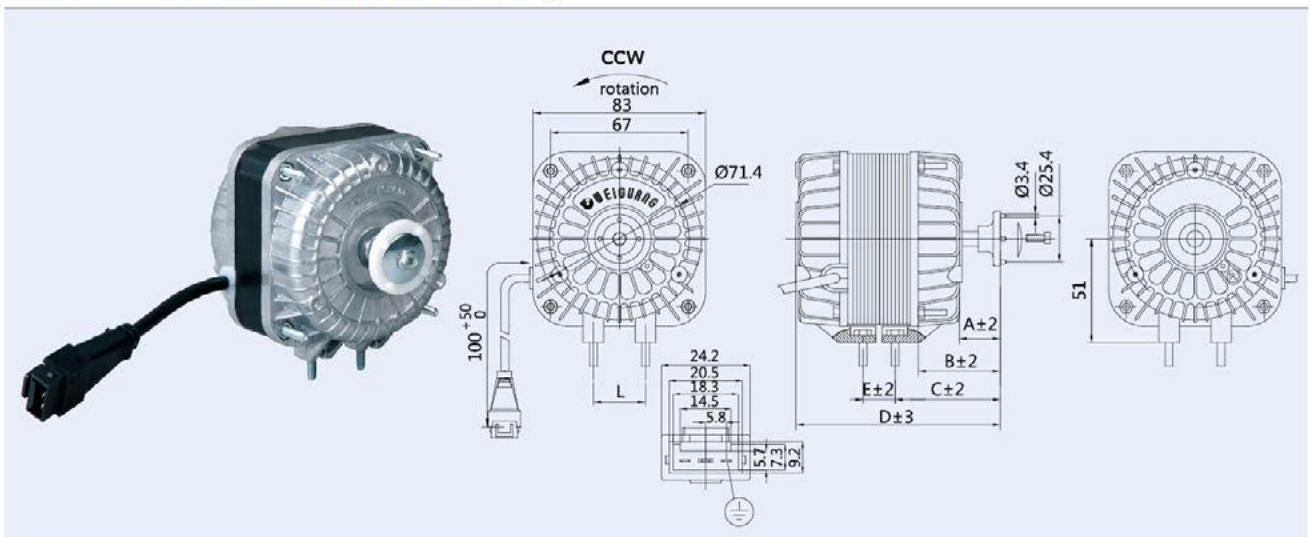

Specification 电机性能参数表

| TYPE 型号 | VOLTAGE 额定电压 V | FREQUENCY 额定频率 Hz | RATED INPUT 额定功率 W | OUTPUT 输出功率 W | RATED CURRENT 额定电流 A | RATED SPEED 额定转速 r/min | AIR VOLUME 额定风量 m ³ /h | FAN BLADE 风叶型号 mm | NET WEIGHT 净重 kg | A | B | C | D | E | F |
|------------|----------------------|-------------------------|--------------------------|---------------------|----------------------------|------------------------------|---|-------------------------|------------------------|------|------|------|-----|----|------|
| | | | | | | | | | | mm | mm | mm | mm | mm | mm |
| YZF 2-13 | 220-240 | 50/60 | 20 | 2 | 0.14 | 1300 | 205 | Φ172 | 0.8 | 16.5 | 35.5 | 46 | 81 | - | 45 |
| YZF 5-13 | 220-240 | 50/60 | 29 | 5 | 0.20 | 1300 | 455 | Φ200 | 0.8 | 16.5 | 35.5 | 46 | 81 | - | 45 |
| YZF 6-13 | 110-120 | 60 | 33 | 6 | 0.55 | 1550 | 510 | | | | | | | | |
| YZF 7-20 | 220-240 | 50/60 | 31 | 7 | 0.23 | 1300 | 640 | Φ230 | 1.1 | 16.5 | 35.5 | 46 | 87 | - | 51 |
| YZF10-20 | 220-240 | 50/60 | 36 | 10 | 0.25 | 1300 | 650 | Φ230 | 1.1 | 16.5 | 35.5 | 46 | 87 | - | 51 |
| | 110-120 | 60 | 55 | 10 | 0.80 | 1550 | 800 | | | | | | | | |
| YZF12-20 | 220-240 | 50/60 | 54 | 12 | 0.36 | 1300 | 690 | Φ230 | 1.1 | 16.5 | 35.5 | 46 | 87 | - | 51 |
| YZF16-25 | 220-240 | 50/60 | 60 | 16 | 0.45 | 1300 | 760 | Φ254 | 1.4 | 15.5 | 34.5 | 45 | 92 | - | 56 |
| YZF18-25 | 110-120 | 60 | 70 | 18 | 1.01 | 1550 | 940 | | | | | | | | |
| YZF18-30 | 220-240 | 50/60 | 70 | 18 | 0.50 | 1300 | 1000 | Φ254 | 1.5 | 18 | 38 | 48.5 | 101 | 21 | 64.5 |
| | 110-120 | 60 | 75 | 18 | 1.00 | 1450 | | | | | | | | | |
| YZF25-40 | 220-240 | 50/60 | 90 | 25 | 0.70 | 1300 | 1030 | Φ300 | 1.8 | 19 | 39 | 49.5 | 112 | 31 | 75.5 |
| | 110-120 | 60 | 100 | 25 | 1.40 | 1450 | | | | | | | | | |
| YZF34-45 | 220-240 | 50/60 | 110 | 34 | 0.85 | 1300 | 1210 | Φ300 | 2.0 | 23 | 43 | 53.5 | 121 | 36 | 84.5 |
| | 110-120 | 60 | 110 | 34 | 1.50 | 1450 | | | | | | | | | |

YZF系列 罩极电机安装方式 Installation of Shaded Pole Motor

A、网罩、法兰安装

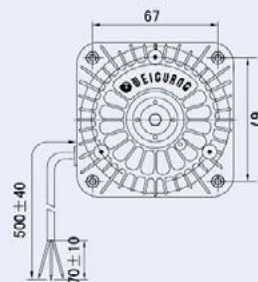

With Grid or Ring

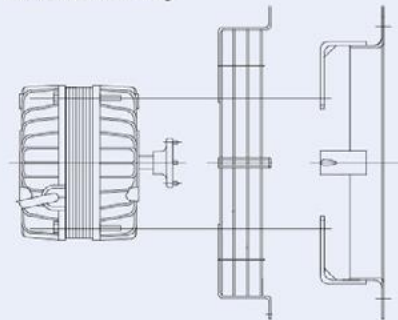

B、支架安装 With Bracket

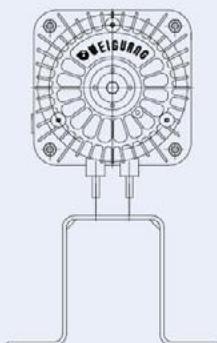

C、电机端盖孔安装 With 3 holes on endshield

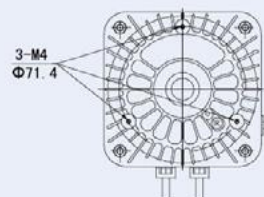

YCF 电容电机 Capacitance Motors

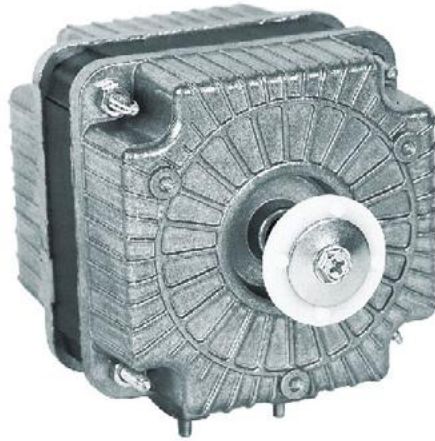

| TYPE 型号 | VOLTAGE 额定电压 V | FREQUENCY 频率 Hz | RATED INPUT 额定功率 W | OUT PUT 输出功率 W | RATED CURRENT 额定电流 A | RATED SPEED 额定转速 r/min | AIR VOLUME 额定风量 m ³ /h | CAPACITANCE 电容型号 μF | FAN BLADE 风叶型号 mm | NET WEIGHT 净重 kg | A mm | B mm | C mm | D mm |
|------------|----------------------|-----------------------|--------------------------|----------------------|----------------------------|------------------------------|---|---------------------------|-------------------------|------------------------|---------|---------|---------|---------|
| YCF10-13-4 | 230 | 50 | 40 | 10 | 0.20 | 1300 | 650 | 1 | Φ230/25° | 0.8 | 12 | 33 | 43 | 78 |
| YCF20-20-2 | 230 | 50 | 55 | 20 | 0.25 | 2500 | 800 | 2 | Φ200/28° | 1.2 | 17 | 38 | 52.5 | 99 |
| YCF20-20-4 | 230 | 50 | 50 | 20 | 0.25 | 1300 | 860 | 1.5 | Φ254/31° | 1.2 | 17 | 38 | 52.5 | 99 |
| YCF40-25-2 | 230 | 50 | 115 | 40 | 0.45 | 2500 | 1140 | 3 | Φ254/19° | 1.4 | 17 | 38 | 52.5 | 104 |
| YCF30-30-2 | 230 | 50 | 140 | 30 | 0.60 | 2500 | 1400 | 3 | Φ254/28° | 1.6 | 17 | 38 | 52.5 | 109 |
| YCF30-30-4 | 230 | 50 | 75 | 30 | 0.35 | 1300 | 1280 | 2 | Φ300/28° | 1.6 | 17 | 38 | 52.5 | 109 |
| YCF80-50-2 | 230 | 50 | 200 | 80 | 0.95 | 2500 | 1930 | 8 | Φ300/19° | 2.5 | 28 | 49 | 63.5 | 140 |
| YCF60-50-4 | 230 | 50 | 120 | 60 | 0.55 | 1300 | 1970 | 3 | Φ300/34° | 2.5 | 28 | 49 | 63.5 | 140 |

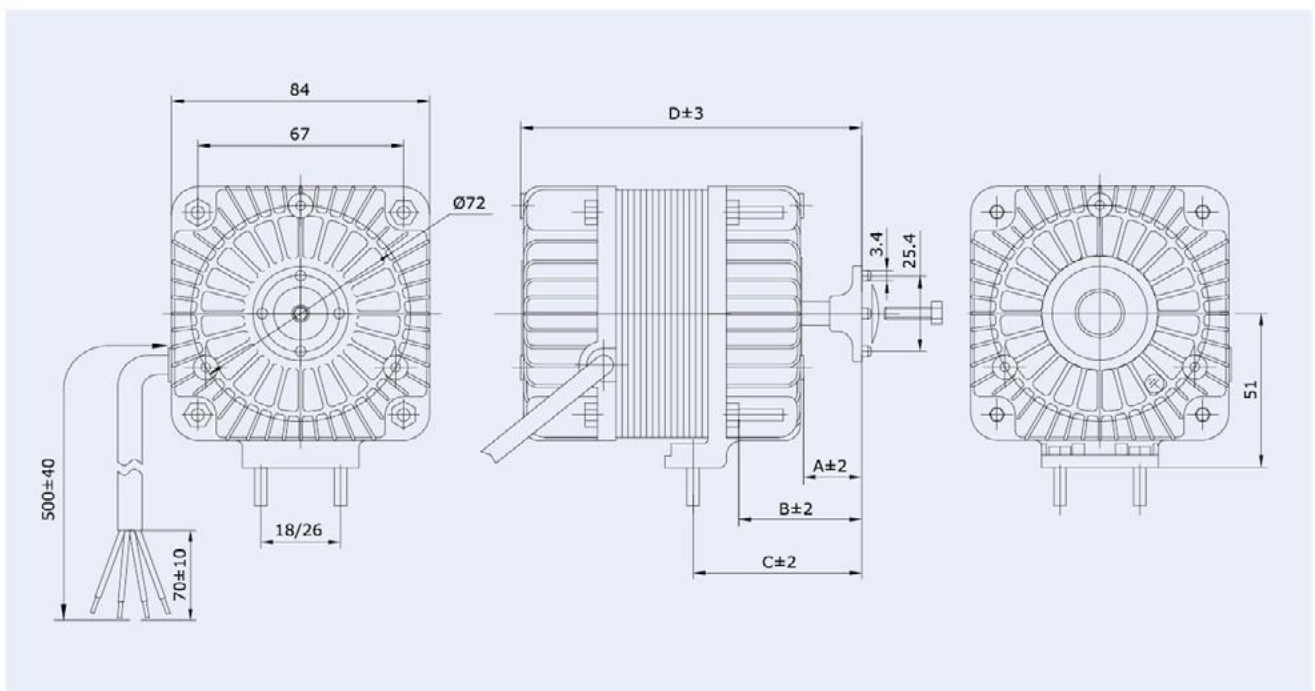

YZF 风量曲线 Air Flow

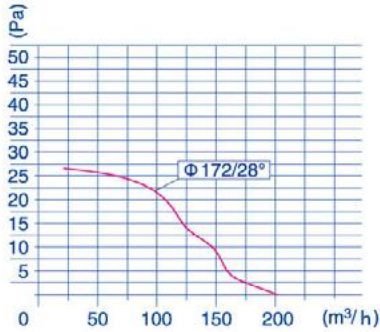

YZF2-13 50Hz Air Flow 空气量

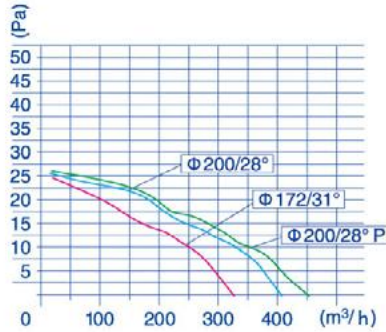

YZF5-13 50Hz Air Flow 空气量

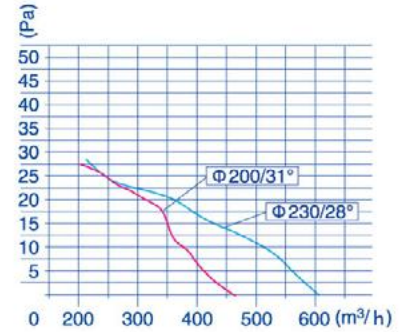

YZF7-20 50Hz Air Flow 空气量

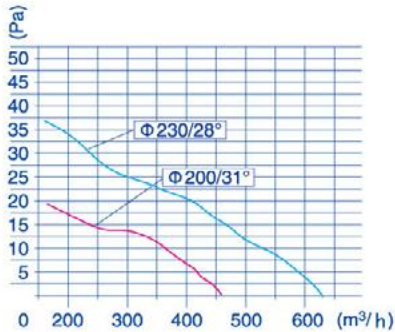

YZF10-20 50Hz Air Flow 空气量

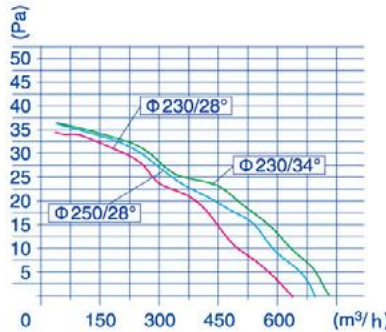

YZF12-20 50Hz Air Flow 空气量

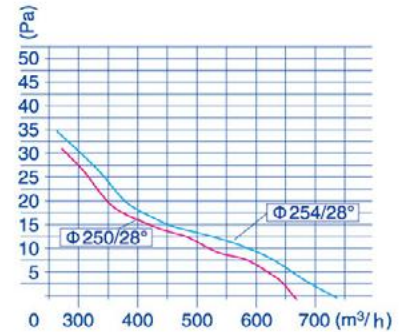

YZF16-25 50Hz Air Flow 空气量

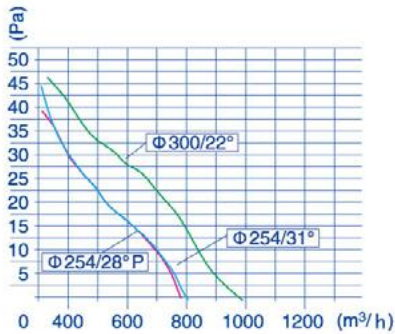

YZF18-30 50Hz Air Flow 空气量

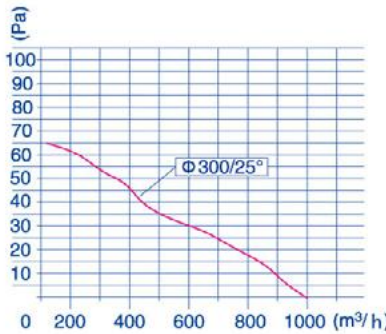

YZF25-40 50Hz Air Flow 空气量

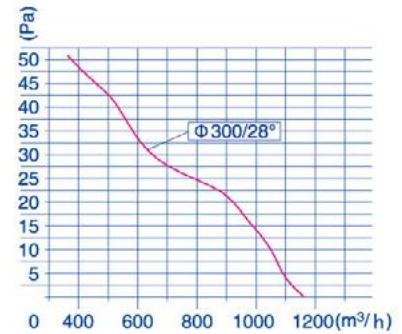

YZF34-45 50Hz Air Flow 空气量

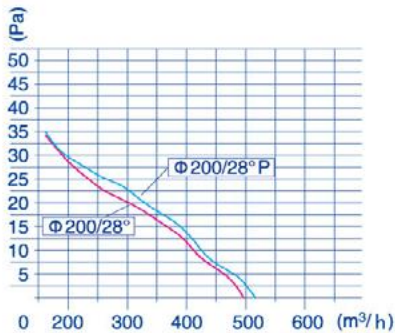

YZF6-13 60Hz Air Flow 空气量

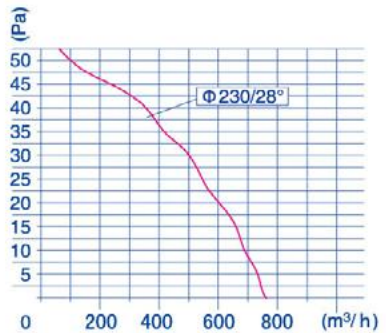

YZF10-20 60Hz Air Flow 空气量

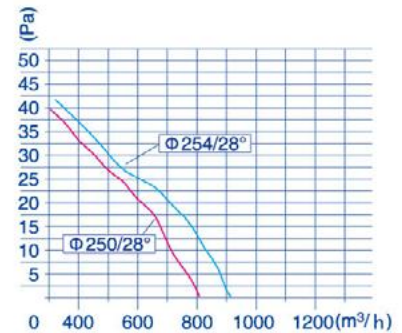

YZF18-25 60Hz Air Flow 空气量

FAN BLADE 叶片 Shaded Pole motors' Accessories

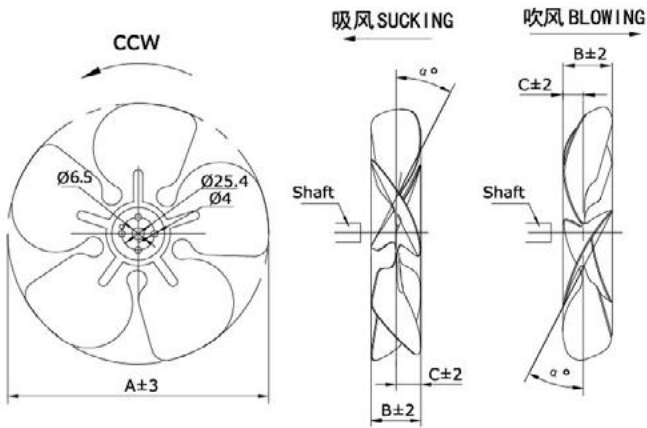

| FAN TYPE | α | 19° | | 22° | | 25° | | 28° | | 31° | | 34° | |
|----------|-----|-----|----|-----|----|-----|----|-----|----|-----|----|-----|----|
| | | A | B | C | B | C | B | C | B | C | B | C | B |
| Φ154 | 154 | 23 | 12 | 26 | 13 | 29 | 15 | 32 | 17 | 36 | 18 | 39 | 21 |
| Φ172 | 172 | 25 | 13 | 28 | 14 | 31 | 16 | 34 | 17 | 38 | 18 | 41 | 21 |
| Φ200 | 200 | 27 | 14 | 30 | 15 | 33 | 17 | 36 | 19 | 40 | 20 | 43 | 22 |
| Φ230 | 230 | 30 | 15 | 33 | 16 | 36 | 19 | 39 | 21 | 42 | 21 | 45 | 23 |
| Φ250 | 248 | 31 | 15 | 34 | 16 | 37 | 19 | 40 | 20 | 43 | 21 | 45 | 22 |
| Φ254 | 254 | 32 | 15 | 35 | 16 | 38 | 19 | 41 | 21 | 44 | 22 | 47 | 23 |
| Φ300 | 300 | 32 | 16 | 35 | 17 | 41 | 21 | 44 | 22 | 48 | 25 | 52 | 27 |



| TYPE | YZF2-13 | | YZF5-13 | | YZF7-20 | | YZF10-20 | | YZF12-20 | | YZF16-25 | | YZF18-30 | | YZF25-40 | | YZF34-45 | |
|------|---------|------|---------|------|---------|------|----------|------|----------|------|----------|------|----------|------|----------|------|----------|------|
| | 50Hz | 60Hz | 50Hz | 60Hz | 50Hz | 60Hz | 50Hz | 60Hz | 50Hz | 60Hz | 50Hz | 60Hz | 50Hz | 60Hz | 50Hz | 60Hz | 50Hz | 60Hz |
| Φ154 | 28 | 28 | | | | | | | | | | | | | | | | |
| Φ172 | 28 | 28 | 31 | 31 | | | | | | | | | | | | | | |
| Φ200 | | | 28 | 28 | 31 | 31 | 31 | 31 | | | | | | | | | | |
| Φ230 | | | | | 28 | 28 | 28 | 28 | 34 | 31 | | | | | | | | |
| Φ250 | | | | | | | 22 | 22 | 28 | 28 | 28 | 28 | | | | | | |
| Φ254 | | | | | | | | | | | 28 | 25 | 31 | 28 | | | | |
| Φ300 | | | | | | | | | | | | | 22 | 22 | 25 | 22 | 28 | 25 |

GRID 网罩 Shaded Pole motors' Accessories

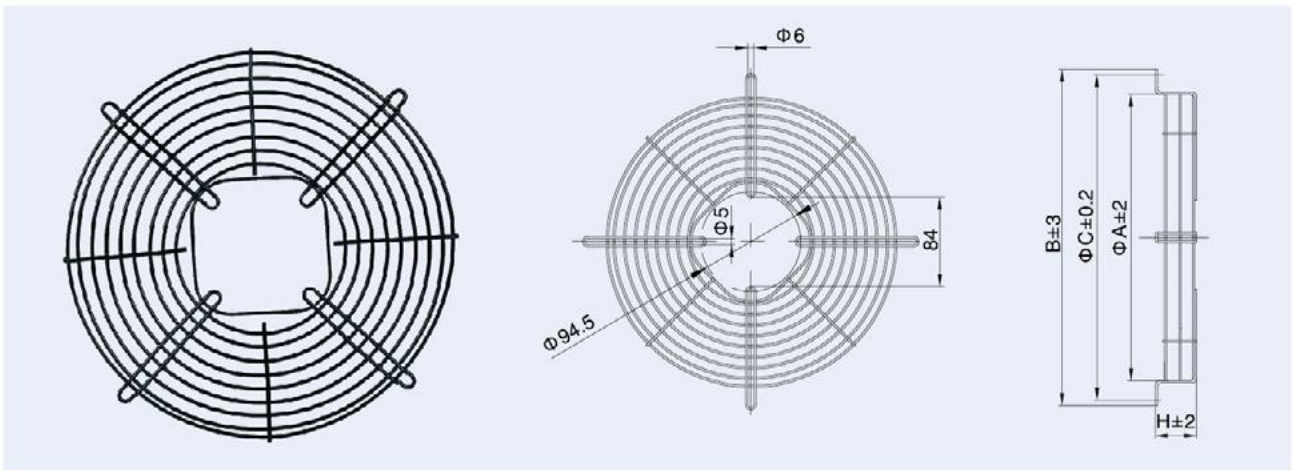

| TYPE | Φ154 | Φ172 | Φ200 | Φ230 | Φ254 | Φ300 |
|------|------|------|------|------|------|------|
| A | 170 | 188 | 214 | 246 | 270 | 324 |
| B | 202 | 220 | 248 | 278 | 302 | 356 |
| C | 190 | 208 | 236 | 266 | 290 | 344 |
| H | 11 | 11 | 25 | 27 | 17 | 17 |

BRACKET 支架

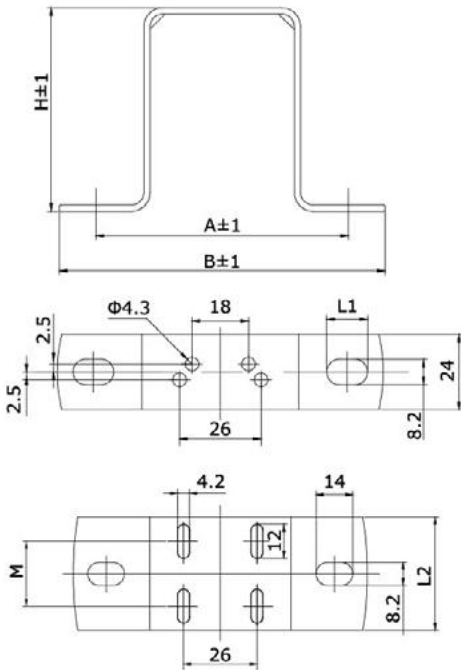

| TYPE | H | A | B | L1 | L2 | M |
|--------|-----|----|-----|----|----|----|
| H39 | 39 | 78 | 100 | 14 | - | - |
| H55 | 55 | 81 | 106 | 13 | - | - |
| H72 | 72 | 81 | 106 | 13 | - | - |
| H84 | 84 | 81 | 106 | 20 | - | - |
| H92 | 92 | 81 | 106 | 14 | - | - |
| H109-1 | 109 | 81 | 106 | 14 | - | - |
| H109-2 | 109 | 78 | 100 | 14 | 39 | 21 |
| H109-3 | 109 | 78 | 100 | 14 | 49 | 29 |

RING 法兰

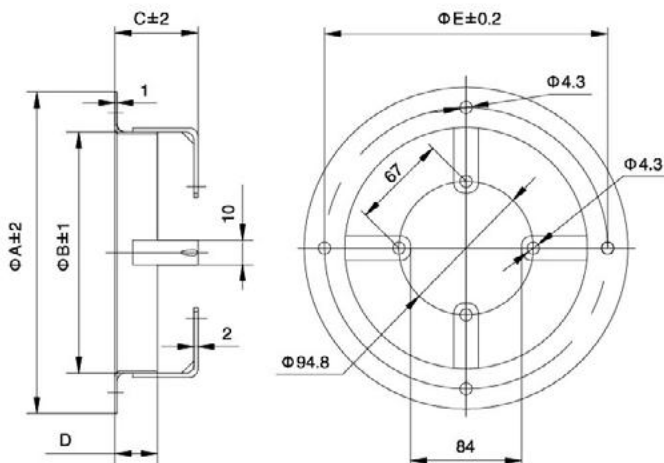

SUCKING

| TYPE | ΦA | ΦB | C | D | ΦE |
|------------|----------|----------|----|----|----------|
| $\Phi 154$ | 200 | 162 | 49 | 25 | 190 |
| $\Phi 172$ | 223 | 180 | 49 | 25 | 208 |
| $\Phi 200$ | 246 | 208 | 49 | 25 | 236 |
| $\Phi 230$ | 278 | 238 | 49 | 25 | 266 |
| $\Phi 254$ | 300 | 268 | 49 | 25 | 290 |
| $\Phi 300$ | 378 | 308 | 49 | 30 | 365 |